

**NSDL e-Governance Infrastructure Ltd**

**Central Recordkeeping Agency**



**Standard Operating Procedure for Subscribers**

**For**

**PAN based PRAN generation through NSDL NPS**

The NSDL NPS module being offered to Subscribers is an online portal hosted by NSDL-CRA on behalf of POPs wherein a Subscriber can register online and make contribution. A link is displayed on POP website for opening NPS account. After clicking on the link, Subscriber will be redirected to NSDL NPS application for registration. The process of PRAN generation is PAN based. Subscriber is required to fill the details (Personal details, bank details, nomination, scheme preference and personal details).

Further, an existing active account with the POP is required before initiating the registration. Also ensure that the details provided for your NPS account (address and Date of Birth) should match with the records available with the POP for which KYC has been carried out. The name provided under NPS should match with the name appearing on PAN

### Step by step guide for Subscriber for registration through NSDL NPS:

1. Click on the link available on POP website for Subscriber registration. You will be directed to Landing Page of NSDL NPS application as below. Brief "Steps for registration" and "FAQs" are available on the Landing page for your quick reference. An existing customer with POP will be able to register through this portal. Please click "Registration" button.

Welcome to "NSDL NPS" - A faster, hassle free and paperless mode of opening NPS Account - Online.  
Requirement for opening NPS Account through "NSDL NPS"

- > A Mobile number and Email ID
- > Active Bank account with Net Banking facility with one of the Banks linked with Payment Gateway Service Provider ([click here](#) for List of Banks)
- > Scanned copy of photograph (Optional) and signature within stipulated size
- > Scanned copy of cancelled cheque supporting the bank account details provided for registering under NPS
- > Online payment of initial contribution (Minimum amount ₹ 500) through Internet Banking

✓ NPS account can be opened by All India Citizens between 18-65 years through "NSDL NPS" (Except NRIs)  
✓ PRAN in NPS is portable across sectors and locations  
✓ Government employees mandatorily covered under NPS, are requested to approach their Nodal Office for opening NPS account

For features and benefits of NPS please visit NSDL CRA website. [www.npscra.nsdl.co.in](http://www.npscra.nsdl.co.in)

Please ensure you have an existing active account with the POP before initiating the registration. Also ensure that the details provided for your NPS account (address and Date of Birth) should match with the records available with the POP for which KYC has been carried out. The name provided under NPS should match with the name appearing on PAN.

[Steps for Registration](#) [REGISTRATION](#) [FAQ](#)

2. Screen as shown below will open. POP name will be populated by default. Please enter "PAN" and click on "Continue" button.

### Online Subscriber Registration

New Registration       Complete Pending Registration       eSign / Print Registration Form

**\* Please ensure "Cookies" are enabled in your browser before proceeding for Registration**  
**Aadhaar based registration under NPS is currently disabled. You may instantly open your NPS account through PAN based Registration.**

New Registration

Choose appropriate options

Individual Subscriber

Status of Applicant	Citizens of India
Register With	<input checked="" type="radio"/> Permanent Account Number (PAN)
Account Type	<input type="radio"/> Tier I & Tier II <input checked="" type="radio"/> Tier I only

Please enter the following details

POP Name	Kotak Mahindra Bank Limited
Enter PAN *	CC [REDACTED]

3. Subscriber is required to fill the details (Personal details, bank details, nomination, scheme preference and personal details). After filling all the personal details, click on "Generate Acknowledgement No."

# Subscriber Registration



Account Type: Tier I

- Personal Details
- Contact Details
- Bank & Other Details
- Nomination Details
- Documents Upload
- Photo & Signature Details
- Payment Details

Fields marked with \* are mandatory for registration.

Personal Details		Family Details	
Title *	SHRI	Father's Title *	SHRI
Please provide the name matching with the Account maintained with the POP.			
First Name *		Father's First Name *	
Middle Name		Father's Middle Name	
Last Name		Father's Last Name	
Date of Birth *		Mother's Title *	SELECT
Gender *	MALE	Mother's First Name *	
Place/City of Birth *	MUMBAI	Mother's Middle Name	
Country of Birth *	INDIA	Mother's Last Name	
Marital Status *	SINGLE	Subscriber's Maiden Name	
Name to be printed on Pran card	FATHER'S NAME		
Mobile *	+91 98		
Email ID *	sagars@nsdl.co.in		
Telephone (Residence No)			
Telephone (Office No)			
Fax Number			
Identity Details		Proof of Identity	
PAN		Identity Proof *	PAN CARD
Passport No		ID Number*	
Voter ID		Date of Birth Proof*	PAN CARD
CERSAI ID		Document Proof ID (if any)	
Agency Code			
Add and Enter Captcha		9 8 + 2 = 100	
<a href="#">Generate Acknowledgement No</a>		<a href="#">Reset</a>	»»

4. A Pop-up will be displayed if the name does not match with PAN database. Subscriber need to click on “Proceed” is he wants to continue or “Cancel” to re-enter name as per PAN database.

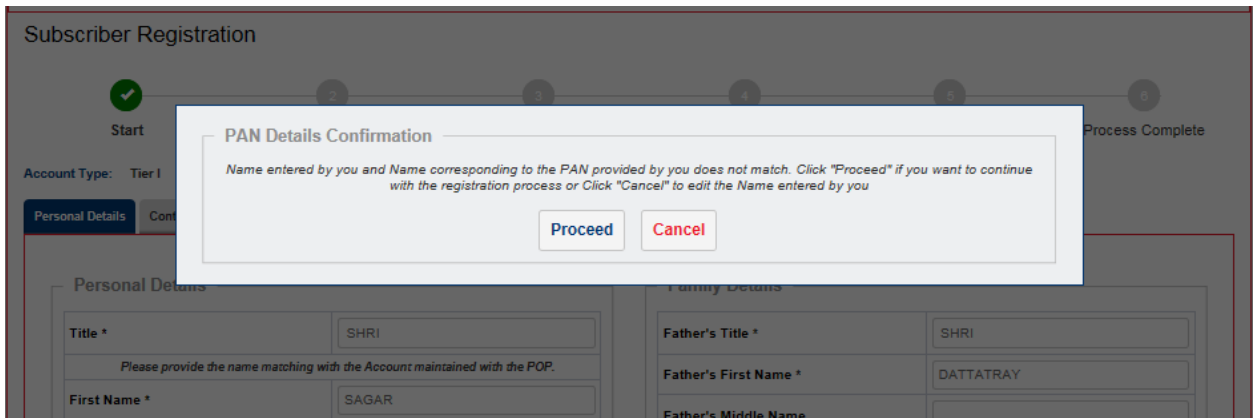

5. After clicking on “Proceed”, acknowledgement number will be generated and the same will be sent to registered mobile no. and Email ID.

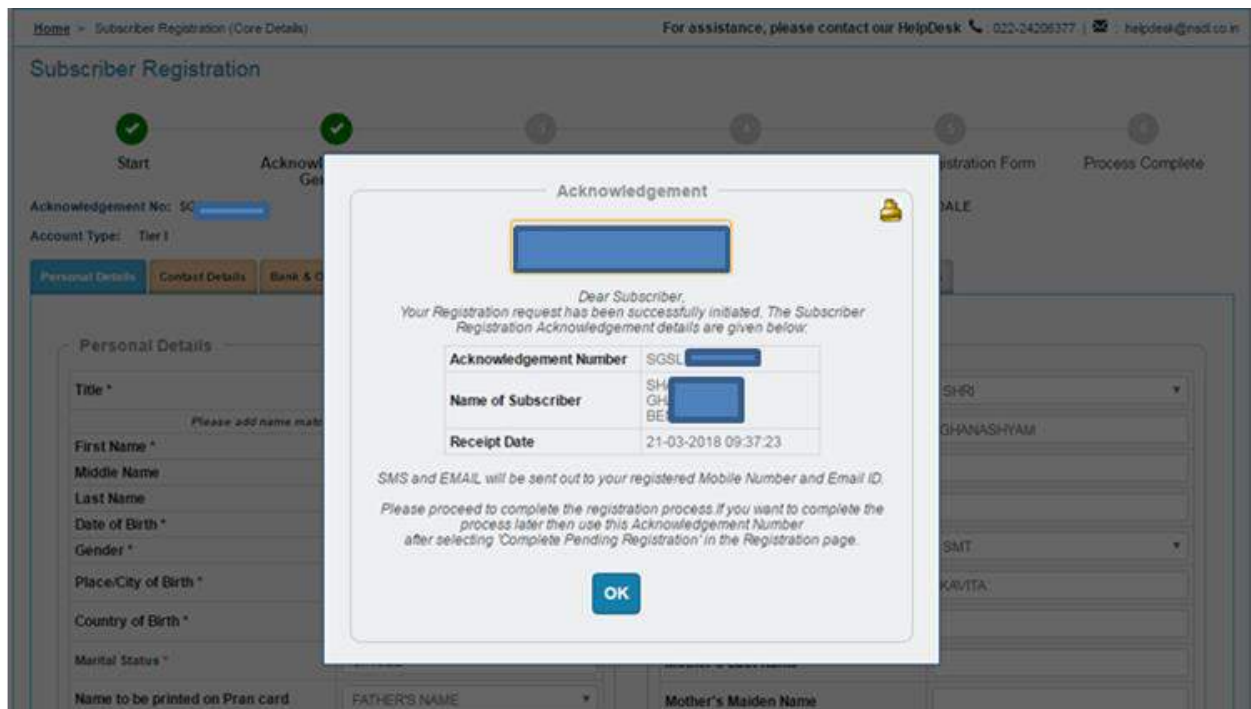

- After clicking on "Ok", Subscriber will be directed to fill up contact details. He is required to fill FATCA details, Permanent address & Correspondence address details (address should match as per POP database in order to avoid rejection of KYC verification). If Permanent address is same as Correspondence address then subscriber is required to click on check box.

### Subscriber Registration

✔  
 Start

✔  
 Acknowledgement ID  
 Generated

3  
 Registration Details Submitted

4  
 PRAN Generated

5  
 eSIGN Registration Form

6  
 Process Complete

Acknowledgement No: KMBK11006024      Subscriber Name: SAGAR SALUNKHE

Account Type: Tier I

Personal Details
Contact Details
Bank & Other Details
Nomination Details
Documents Upload
Photo & Signature Details
Payment Details

The address entered in myNPS should be the same as per POP records. Otherwise your request is liable to be rejected.

**FATCA Details**

US PERSON
 YES  NO

Country of Tax residency	Address of Tax residency	TIN Number issuing Country	Tax Identification Number	Validity	FATCA State	FATCA City	FATCA Zip Code
INDIA	INDIA	INDIA	BQPPS1056N		MAHARASHTRA	MUMBAI	400013

Add

### Correspondence Address Details

Address Type *	
<input type="radio"/> Unspecified <input type="radio"/> Business <input checked="" type="radio"/> Residential <input type="radio"/> Residential/Business <input type="radio"/> Registered Office	
Flat/Room/Door/Block no. *	GHATKOPER
Landmark	GHATKOPER
Premises/Building/Village	GHATKOPER
Road/Street/Lane	GHATKOPER
Area/Locality/Taluka	GHATKOPER
PIN Code *	400013 <input type="button" value="Q"/>
City/Town/District *	MUMBAI
State/U.T. *	MAHARASHTRA
Country *	INDIA
Correspondence Address Proof *	Document Proof ID (if any)
VOTER IDENTITY CARD	

### Permanent Address Details

Check in case if the address is same as above.

Address Type *	
<input type="radio"/> Unspecified <input type="radio"/> Business <input checked="" type="radio"/> Residential <input type="radio"/> Residential/Business <input type="radio"/> Registered Office	
Flat/Room/Door/Block no. *	GHATKOPER
Landmark	GHATKOPER
Premises/Building/Village	GHATKOPER
Road/Street/Lane	GHATKOPER
Area/Locality/Taluka	GHATKOPER
PIN Code *	400013 <input type="button" value="Q"/>
City/Town/District *	MUMBAI
State/U.T. *	MAHARASHTRA
Country *	INDIA
Permanent Address Proof *	Document Proof ID (if any)
VOTER IDENTITY CARD	



Save & Proceed

Reset



7. As a next step, please fill "Bank & Other details" and then click on "Save and Proceed".

**Subscriber Registration**

Start Acknowledgement ID Generated Registration Details Submitted PRAN Generated eSIGN Registration Form Process Complete

Acknowledgement No: KMBK11006024 Subscriber Name: SAGAR SALUNKHE

Account Type: Tier I

Personal Details Contact Details **Bank & Other Details** Nomination Details Documents Upload Photo & Signature Details Payment Details

**Other Details**

Occupation Details *	PUBLIC SECTOR
Income Range (per annum)	5 LAC TO 10 LAC
Educational Qualification	GRADUATE
Please Select If Applicable	-- NOT APPLICABLE --
Relative of Political Exposed Person	--SELECT--

**Tier 1**

**Bank Details**

\* All details are Mandatory

Account Type	SAVINGS ACCOUNT
Bank A/c Number	
Bank IF S Code	
Bank Name	INDIA
Branch Name	KOLKATA MAIN
Branch Address	SAMRIDDIHI BHAWAN 1 STRAND ROAD KOLKATA 700 001
PIN Code	400013
State/U.T.	MADHYA PRADESH
Country	INDIA
Bank MICR Code	700002021
Bank A/c Linked to Aadhaar	<input type="checkbox"/>

« Save & Proceed Reset »

8. After clicking on Save and Proceed, Please enter Scheme Preference details and Nominee details.



## Subscriber Registration



Start



Acknowledgement ID  
Generated

3

Registration Details Submitted

4

PRAN Generated

5

eSIGN Registration Form

6

Process Complete

Acknowledgement No: KMBK11006024

Subscriber Name: SAGAR SALUNKHE

Account Type: Tier I

Personal Details

Contact Details

Bank & Other Details

**Nomination Details**

Documents Upload

Photo & Signature Details

Payment Details

Tier I

### Scheme Preference Details

Choose Pension Fund Manager (PFM):\*

HDFC PENSION MANAGEMENT COMPANY LIMITED

Choose your Investment Option wisely:\*

Auto  Active

Moderate  Conservative  Aggressive

Sr No.	Scheme Name	% Distribution
1	HDFC PENSION MANAGEMENT COMPANY LIMITED SCHEME E - TIER I	50
2	HDFC PENSION MANAGEMENT COMPANY LIMITED SCHEME C - TIER I	30
3	HDFC PENSION MANAGEMENT COMPANY LIMITED SCHEME G - TIER I	20

### Nominee Details

Nominee 1

First Name *	<input type="text"/>
Middle Name	<input type="text"/>
Last Name / Surname	<input type="text"/>
Major/Minor*	MAJOR
Date of Birth	<input type="text"/> (DD/MM/YYYY)
Relationship*	FATHER
Percentage Share*	100 %
Guardian First Name (in case of a minor)	<input type="text"/>
Guardian Middle Name	<input type="text"/>
Guardian Last Name	<input type="text"/>
Flat/Room/Door/Block no.*	LOWERPAREL
Premises/Building/Village	LOWERPAREL
Area/Locality/Taluka	LOWERPAREL
PIN Code/ZIP Code	400013 <input type="text"/>
City	MUMBAI
State/U.T.	MAHARASHTRA
Country	INDIA

Add



Save & Proceed

Reset



9. Further, you are required to upload scan copy of "PAN card" & "Cancelled Cheque".

**Subscriber Registration**

Start  Acknowledgement ID Generated  Registration Details Submitted  PRAN Generated  eSIGN Registration Form  Process Complete

Acknowledgement No: KMBK11006024      Subscriber Name: SAGAR SALUNKHE

Account Type: Tier I

Personal Details | Contact Details | Bank & Other Details | Nomination Details | **Documents Upload** | Photo & Signature Details | Payment Details

**Documents Upload**

Proof Name	Document Name	Attach File	
SCANNED PAN CARD *	SCANNED PAN CARD	E:\MIS DATA\TESTING\PHOTSIGN\ESIGNED_17000\ Browse...	
CANCELLED CHEQUE *	CANCELLED CHEQUE	E:\MIS DATA\TESTING\PHOTSIGN\ESIGNED_17000\ Browse...	

Note: Document should be in \*.jpeg, \*.jpg or \*.pdf format. Size of document should be between 4KB and 2MB.

«  »

10. After clicking on "Upload", subscriber is required to upload the Photo & Signature and then click on "Save" button.

## Subscriber Registration

Start  Acknowledgement ID Generated  Registration Details Submitted  PRAN Generated  eSIGN Registration Form  Process Complete

Acknowledgement No: KMBK11006024 Subscriber Name: SAGAR SALUNKHE

Account Type: Tier I

Personal Details | Contact Details | Bank & Other Details | Nomination Details | Documents Upload | **Photo & Signature Details** | Payment Details

Upload Photo & Signature

Photo

Preview Photo

E:\MIS DATA\TESTING\ Browse...

Signature

Preview Signature

E:\MIS DATA\TESTING\ Browse...

**Steps to Scan Signature**

*Note: Photo & Signature should be in \*.jpg format. If your Photograph/Signature image is in other format, please save it as in .jpg format. Size of photo should be between 4KB and 20KB. Scan a signature and upload it.*

« Save

11. Please re-verify the Photo and signature and then click on "Confirm".

## Subscriber Registration

Start  Acknowledgement ID Generated  Registration Details Submitted  PRAN Generated  eSIGN Registration Form  Process Complete

Acknowledgement No: KMBK11006024 Subscriber Name: SAGAR SALUNKHE

Account Type: Tier I

Personal Details | Contact Details | Bank & Other Details | Nomination Details | Documents Upload | **Photo & Signature Details** | Payment Details

Upload Photo & Signature

Photo

Preview Photo

Photo Successfully Uploaded

Browse...

Signature

Preview Signature

Signature Successfully Uploaded

Browse...

**Steps to Scan Signature**

*Note: Photo & Signature should be in \*.jpg format. If your Photograph/Signature image is in other format, please save it as in .jpg format. Size of photo should be between 4KB and 20KB. Scan a signature and upload it.*

« Save Confirm

12. After clicking on "Confirm", system will display all the details which are entered under "Personal details, Contact details, Bank details, Nomination details, Scheme Preference, Documents and Photo Signature. If there is any issue with the details entered, then you can click on "Edit" button and rectify the details. Once the details are verified, click on "Proceed".

### Subscriber Registration

A progress bar showing six steps: 1. Start (green checkmark), 2. Acknowledgement ID Generated (green checkmark), 3. Registration Details Submitted (green checkmark), 4. PRAN Generated (grey circle), 5. eSIGN Registration Form (grey circle), 6. Process Complete (grey circle).

Acknowledgement No: KMBK11006024      Subscriber Name: SAGAR SALUNKHE  
 Account Type: Tier I

Navigation tabs: Personal Details (active), Contact Details, Bank & Other Details, Nomination Details, Documents Upload, Photo & Signature Details, Payment Details

#### Personal Details

Title	SHRI
First Name *	SAGAR
Middle Name	DATTATRAY
Last Name	SALUNKHE
Gender *	MALE
Date of Birth *	27/12/1984
Place/City of Birth *	MUMBAI
Country of Birth *	INDIA
Marital Status	SINGLE
Name to be printed on Pran card	FATHER'S NAME
Mobile *	+ 91 9987044179
Email ID *	SAGARS@NSDL.CO.IN
Telephone (Residence No)	
Telephone (Office No)	
Fax Number	

#### Family Details

Father's Title *	SHRI
Father's First Name *	DATTATRAY
Father's Middle Name	
Father's Last Name	
Mother's Title *	SMT
Mother's First Name	TRUPTI
Mother's Middle Name	
Mother's Last Name	
Subscriber's Maiden Name	

#### Identity Details

PAN	CCMPB7485C
Aadhaar	
Passport No	
Voter ID	
CERSAI ID	
Agency Code	

#### Proof of Identity

Identity Proof	PAN CARD
Document ID	CCMPB7485C
Date of Birth Proof	PAN CARD
Document Proof ID (if any)	CCMPB7485C

Edit
»»

## Subscriber Registration

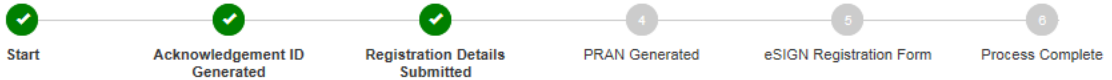

Acknowledgement No: KMBK11006024

Subscriber Name: SAGAR SALUNKHE

Account Type: Tier I

- Personal Details
- Contact Details
- Bank & Other Details
- Nomination Details
- Documents Upload
- Photo & Signature Details
- Payment Details

### FATCA Details

US PERSON		NO					
Country of Tax residency	Address of Tax residency	TIN Number issuing Country	Tax Identification Number	Validity	FATCA State	FATCA City	FATCA Zip Code
INDIA	INDIA	INDIA	BQPPS1056N		MAHARASHTRA	MUMBAI	400013

### Correspondence Address Details \*

Address Type *	Residential
Flat/Room/Door/Block no. *	GHATKOPER
Landmark	GHATKOPER
Premises/Building/Village	GHATKOPER
Road/Street/Lane	GHATKOPER
Area/Locality/Taluka	GHATKOPER
PIN Code *	400013
City/Town/District *	MUMBAI
State/U.T. *	MAHARASHTRA
Country *	INDIA

	Document Description	Document ID
Address Proof	VOTER IDENTITY CARD	

### Permanent Address Details \*

Same As Current Address

Address Type *	Residential
Flat/Room/Door/Block no. *	GHATKOPER
Landmark	GHATKOPER
Premises/Building/Village	GHATKOPER
Road/Street/Lane	GHATKOPER
Area/Locality/Taluka	GHATKOPER
PIN Code *	400013
City/Town/District *	MUMBAI
State/U.T. *	MAHARASHTRA
Country *	INDIA

	Document Description	Document ID
Address Proof	VOTER IDENTITY CARD	



Edit



## Subscriber Registration

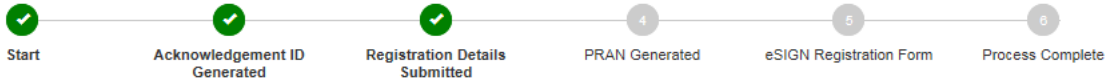

Acknowledgement No: KMBK11006024

Subscriber Name: SAGAR SALUNKHE

Account Type: Tier I

- Personal Details
- Contact Details
- Bank & Other Details**
- Nomination Details
- Documents Upload
- Photo & Signature Details
- Payment Details

### Other Details

Occupation Details	PUBLIC SECTOR
Educational Qualification	GRADUATE
Income Range (per annum)	5 lac to 10 lac
Please Select If Applicable	-- NOT APPLICABLE --
Relative of Political Exposed Person	

### Tier 1

#### Bank Details

Account Type	SAVINGS
Bank A/C Number	54654846464654
Bank IFS Code	SBIN0000001
Bank Name	STATE BANK OF INDIA
Branch Name	KOLKATA MAIN
Branch Address	SAMRIDDHI BHAWAN 1 STRAND ROAD KOLKATA 700 001
PIN Code	400013
State/U.T.	MADHYA PRADESH
Country	INDIA
Bank MICR Code	700002021
Bank A/c Linked to Aadhaar	<input type="checkbox"/>



Edit



## Subscriber Registration

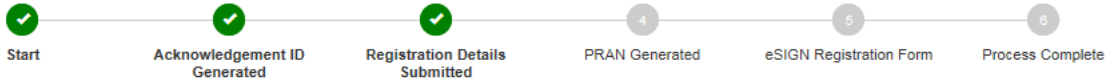

Acknowledgement No: KMBK11006024

Subscriber Name: SAGAR SALUNKHE

Account Type: Tier I

Personal Details    Contact Details    Bank & Other Details    **Nomination Details**    Documents Upload    Photo & Signature Details    Payment Details

Tier I

### Scheme Preference Details

Choose Pension Fund Manager (PFM):*	HDFC PENSION MANAGEMENT COMPANY LIMITED
Choose your Investment Option wisely:*	Auto
Choose your Investment Option wisely:*	Moderate

Sr No.	Scheme Name	% Distribution
1	HDFC PENSION MANAGEMENT COMPANY LIMITED SCHEME E - TIER I	50.0
2	HDFC PENSION MANAGEMENT COMPANY LIMITED SCHEME C - TIER I	30.0
3	HDFC PENSION MANAGEMENT COMPANY LIMITED SCHEME G - TIER I	20.0

Nominee 1

First Name *	DATTATRAY
Middle Name	
Last Name / Surname	SALUNKHE
Date of Birth	
Relationship *	FATHER
Major/Minor *	Major
Percentage Share *	100%
Guardian First Name (in case of a minor) *	
Guardian Middle Name	
Guardian Last Name	
Flat/Room/Door/Block no.	LOWERPAREL
Premises/Building/Village	LOWERPAREL
Area/Locality/Taluka	LOWERPAREL
PIN Code/ZIP Code	400013
City	MUMBAI
State/U.T.	MAHARASHTRA
Country	INDIA



Edit



## Subscriber Registration



Acknowledgement No: KMBK11006024

Subscriber Name: SAGAR SALUNKHE

Account Type: Tier I

- Personal Details
- Contact Details
- Bank & Other Details
- Nomination Details
- Documents Upload**
- Photo & Signature Details
- Payment Details

### Documents Upload

Proof Name	Document Name	
SCANNED PAN CARD	SCANNED PAN CARD	
CANCELLED CHEQUE	CANCELLED CHEQUE	

Edit

## Subscriber Registration



Acknowledgement No: KMBK11006024

Subscriber Name: SAGAR SALUNKHE

Account Type: Tier I

- Personal Details
- Contact Details
- Bank & Other Details
- Nomination Details
- Documents Upload
- Photo & Signature Details**
- Payment Details

### Preview Photo



### Preview Signature



Edit



13. After clicking on proceed, subscriber is required to make payment for initial contribution.

**Subscriber Registration**

Start Acknowledgement ID Generated Registration Details Submitted PRAN Generated eSIGN Registration Form Process Complete

Acknowledgement No: KMBK11006024 Subscriber Name: SAGAR SALUNKHE

Account Type: Tier I

Personal Details Contact Details Bank & Other Details Nomination Details Documents Upload Photo & Signature Details **Payment Details**

Payment Details

First Time Tier I Contribution Amount	₹ 9814
First Time Tier II Contribution Amount	₹

**Confirm Payment**

«

14. Contribution will consist of Contribution amount (separate for Tier I and Tier II), POP Registration charges, Contribution charges as prescribed by PFRDA (separate for Tier I and Tier II) and GST for the aforesaid charges. You are required to tick on declaration and then click on "Confirm Registration".

## Subscriber Registration

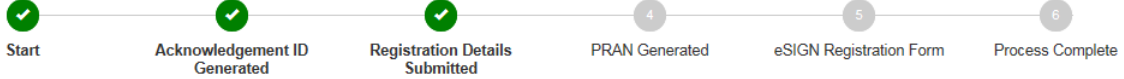

Acknowledgement No: KMBK11006024

Subscriber Name: SAGAR SALUNKHE

Account Type: Tier I

- Personal Details
- Contact Details
- Bank & Other Details
- Nomination Details
- Documents Upload
- Photo & Signature Details
- Payment Details**

### Payment Details

First Time Tier I Contribution Amount	₹ 9814
First Time Tier II Contribution Amount	₹

[Edit Amount](#)

### Summary

	Contribution & POP Charges	GST
Total Contribution(INR)	9814	
Charges for Account Opening(INR)	200.00	36.00
Charges for Contribution(INR)	24.54	4.42
Total amount to be paid(INR)	10078.96	

### Declaration By Subscriber

**Declaration & Authorization by all subscribers**

I have read and understood the terms and conditions of the National Pension System and hereby agree to the same and declare that the information and documents furnished by me are true and correct, to the best of my knowledge and belief. I undertake to inform immediately to POP, of any change in the above information furnished by me. I do not hold any pre-existing account under NPS. I understand that I shall be fully liable for submission of any false or incorrect information or documents

I further agree to be bound by the terms and conditions of provision of services by CRA, from time to time and any amendment thereof as approved by PFRDA, whether complete or partial without any new declaration being furnished by me. I shall be bound by the terms and conditions for the usage of I-pin (to access CRAIN/PSCAN and view details) & T-pin on the CRA website.

I understand that my initial contribution will be credited in my PRAN but I will not be able to make any further contribution till the KYC compliance is confirmed by the POP selected by me during registration. Once the KYC compliance is confirmed by POP, I agree to take a printout of the registration form from myNPS portal, paste photograph, affix signature and send it to POP. I understand that my PRAN will be 'frozen' temporarily if the form is not sent to POP within 90 days from the date of allotment of PRAN.

I hereby declare that I am the bonafide subscriber of NPS and the contribution being paid for this transaction pertains to my PRAN. I further declare that I will make payment from my bank account.

**Declaration under the Prevention of Money Laundering Act, 2002**

I hereby declare that the contribution paid by me has been derived from my legally declared and assessed sources of income. I understand that NSDL NPS has the right to peruse my financial profile or share the information, with other government authorities. I further agree that NSDL NPS has the right to close my PRAN in case I am found violating the provisions of any law relating to prevention of money laundering

**NOTE : Please mention 'NPS Contribution' as remark in the payment remark at your banking site.**

Please confirm the declarations by clicking on the check boxes to proceed.

[Confirm Registration](#)

[Cancel](#)

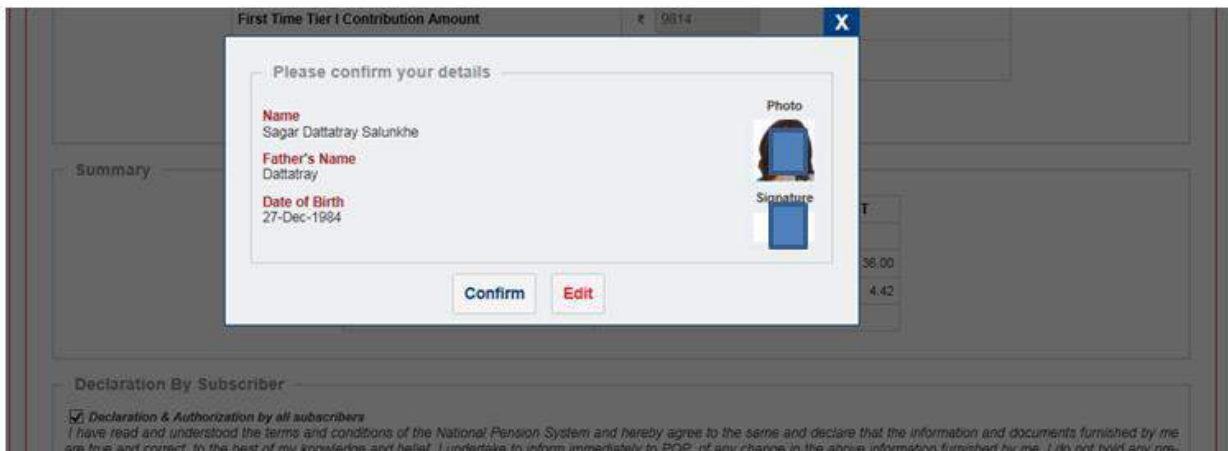

15. Post successful transaction PRAN will be generated for the subscriber and the breakup of the payment done would be displayed in the receipt, which be printed.

The screenshot shows a progress bar with six steps: Start, Acknowledgement ID Generated, Registration Details Submitted, PRAN Generated, eSIGN Registration Form, and Process Complete. The first four steps are marked with green checkmarks, while the last two are greyed out. Below the progress bar is a receipt summary table.

Permanent Retirement Account Number (PRAN)	110122102549	
Name of the Subscriber	AMOL BAJIRAO MAHADIK	
	<b>Contribution &amp; POP Charges</b>	<b>GST</b>
Total Contribution*(INR)	15000.00	
Charges for Account Opening(INR)	200.00	36.00
Charges for Contribution(INR)	38.00	6.84
Total amount paid(INR)	15280.84	
Acknowledgement Number	SGSL11004897	
Contribution Receipt Number	12678890219999977	
Transaction Reference Number	9685513438802	
Transaction Date	2018-03-07 17:33:25	
Transaction Status	Successful	

\* Click on 'Download Registration Form/eSign' for completing the process of e-Sign(digital signing) by submitting the OTP sent by UIDAI to the mobile number registered with UIDAI. Once the process of digitally signing is successfully completed, you need not send the physical copy of the form to CRA.

\* eSign charge ₹ 5 plus Goods & Services Tax (GST)

Buttons: Download Registration Form/ESign, SAVE/PRINT PAYMENT RECEIPT

16. You are required to eSIGN the form post successful completion of transaction.

The screenshot shows the NPS website header with the logo and 'National Pension System Trust' text. The breadcrumb trail is 'Home > Subscriber Registration > eSign / Print & Courier Subscriber Registration Form'. The main content area is titled 'eSign / Print & Courier' and features a progress bar with six steps: Start, Acknowledgement ID Generated, Registration Details Submitted, PRAN Generated, eSIGN Registration Form, and Process Complete. The first four steps are marked with green checkmarks, while the last two are greyed out. Below the progress bar, the Acknowledgement No. is 11529328 and the PRAN No. is 110112650916. The Account Type is Tier I. There are two radio button options: 'eSign Subscriber Registration Form (Paperless)' (selected) and 'Print & Courier Subscriber Registration Form'. A yellow 'eSign & Download' button is located at the bottom.

Home > Subscriber Registration > eSign / Print & Courier Subscriber Registration Form

### eSign / Print & Courier

**Alert!**

Your name provided for PRAN registration should match with Aadhaar records to eSign your Registration Form successfully.

Press 'Proceed' if it is matching. You will be directed to eSign Service Provider website for eSigning of registration document, through successful authentication from UIDAI.  
Press 'Cancel' in case name does not match use the 'Print and Courier Subscriber Registration Form' for further process.

**Proceed** **Cancel**

Start

Acknowledgement No: 1452

Account Type: Tier I

eSign / Print & Cou

eSign (Paperless)

Process Complete

eSign & Download



### eSign Service

ASP Name	National Pension System Trust	Transaction ID	UKCeSign:5763:20190214094559775
Organization	National Pension System Trust	Date & Time	14/02/2019 09:46:23

Enter Aadhaar Number / Virtual ID:

I hereby authorize NSDL e-Governance Infrastructure Limited (NSDL e-Gov) to -

1. Use my Aadhaar / Virtual ID details (as applicable) for eSigning the registration document / service requests under National Pension System (NPS)/Atal Pension Yojana (APY) for/with National Pension System Trust and authenticate my identity through the Aadhaar Authentication system (Aadhaar based e-KYC services of UIDAI) in accordance with the provisions of the Aadhaar (Targeted Delivery of Financial and other Subsidies, Benefits and Services) Act, 2016 and the allied rules and regulations notified thereunder and for no other purpose.
2. Authenticate my Aadhaar / Virtual ID through OTP or Biometric for authenticating my identity through the Aadhaar Authentication system for obtaining my e-KYC through Aadhaar based e-KYC services of UIDAI and use my Photo and Demographic details (Name, Gender, Date of Birth and Address) for eSigning the registration document / service requests under National Pension System (NPS)/Atal Pension Yojana (APY) for/with National Pension System Trust.
3. I understand that Security and confidentiality of personal identity data provided, for the purpose of Aadhaar based authentication is ensured by NSDL e-Gov and the data will be stored by NSDL e-Gov till such time as mentioned in guidelines from UIDAI from time to time.

**Request OTP** **Cancel**

eSign Service			
ASP Name	National Pension System Trust	Transaction ID	UNCeSign:5763:20190214094559775
Organization	National Pension System Trust	Date & Time	14/02/2019 09:46:23

I hereby authorize NSDL e-Governance Infrastructure Limited (NSDL e-Gov) to -

1. Use my Aadhaar / Virtual ID details (as applicable) for eSigning the registration document / service requests under National Pension System (NPS)/Atal Pension Yojana (APY) for/with National Pension System Trust and authenticate my identity through the Aadhaar Authentication system (Aadhaar based e-KYC services of UIDAI) in accordance with the provisions of the Aadhaar (Targeted Delivery of Financial and other Subsidies, Benefits and Services) Act, 2016 and the allied rules and regulations notified thereunder and for no other purpose.
2. Authenticate my Aadhaar / Virtual ID through OTP or Biometric for authenticating my identity through the Aadhaar Authentication system for obtaining my e-KYC through Aadhaar based e-KYC services of UIDAI and use my Photo and Demographic details (Name, Gender, Date of Birth and Address) for eSigning the registration document / service requests under National Pension System (NPS)/Atal Pension Yojana (APY) for/with National Pension System Trust.
3. I understand that Security and confidentiality of personal identity data provided, for the purpose of Aadhaar based authentication is ensured by NSDL e-Gov and the data will be stored by NSDL e-Gov till such time as mentioned in guidelines from UIDAI from time to time.

Enter OTP

OTP sent to the registered mobile number and Email ID.



## National Pension System Trust



---

[Home](#) > eSign Confirmation

### eSign Success - Subscriber Registration

eSign for Subscriber Registration Form is Successful! Please download the eSign form and verify the signature.

\*\*\*\*\*